

Nylon Pipe Spring (For Guarding Nylon Pipe)



Model	Spring Inner Diameter	Suitable Nylon Pipe Outer Dia. x Length	N.W. (g)
SG-41800	Ø4.5	Ø4 x 1800mm	52
SG-61800	Ø6.5	Ø6 x 1800mm	72

Pipe Cutter



Model	Item	N.W. (g)
M25004	Pipe Cutter	30
M25004-1	Blade of Pipe Cutter	2

Manual Pipe Bender



Manual Pipe Bender

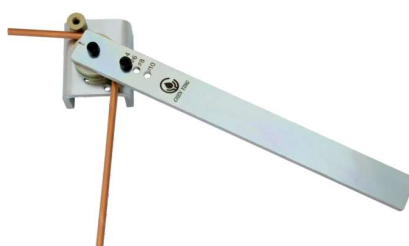

Grooved Disks
(Ø4, Ø6, Ø8, Ø10)

◆ Features

1. Manual pipe bender is suitable for manually bending variable kinds of metal pipes, such as aluminum, copper, steel, and iron.
2. Multiple sizes of grooved disks Ø4, Ø6, Ø8, and Ø10 are available for choice upon demand.
3. Each grooved disk can be purchased individually.

◆ Specification Chart

Order Code	Item	N.W. (g)
TB-4-6-8-10	Manual Pipe Bender with Ø4, Ø6, Ø8, and Ø10 Grooved Disks	1591
PC231001	Ø4 Grooved Disk	115
PC232001	Ø6 Grooved Disk	104
PC233001	Ø8 Grooved Disk	174
PC234001	Ø10 Grooved Disk	289

◆ Order Code (Manual Pipe Bender with Grooved Disks)

TB	4	6	8	10
Manual Pipe Bender	Groove Disk	Groove Disk	Groove Disk	Groove Disk
	4 Ø4	6 Ø6	8 Ø8	10 Ø10



CHEN YING

Manual Pipe Bender

◆ Pipe Bender Fixed Instruction

1. Mount the manual pipe bender on a vise or an H-beam.
2. Screw the base with the hexagonal screws to tighten the pipe bender on a vase or an H-beam.

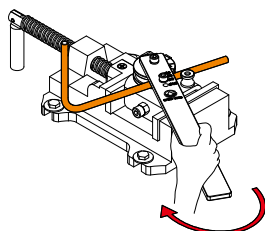

on a Vise

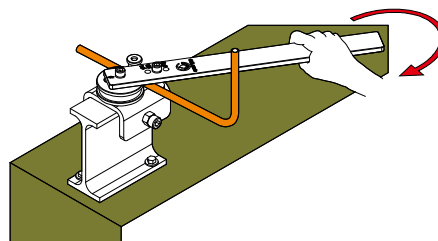

on an H-Beam

◆ Grooved Disk Switch Instruction

- $\varnothing 4$ and $\varnothing 6$ grooved disks

Screw Hole Fixed Hole

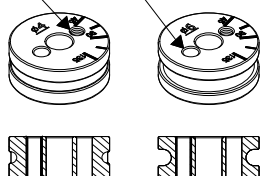

Tighten the screw upwards from the bottom of the pipe bender base to the grooved disks to fix the grooved disks.

• Bending Lever:

Place the grooved disk under the bending lever and fix it on the base holder by the pipe size.

- $\varnothing 8$ and $\varnothing 10$ grooved disks

Fish-Eye Hole Fixed Hole

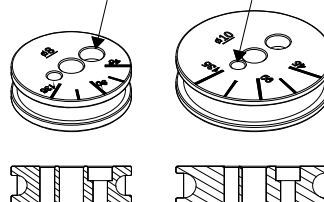

Tighten the screw downwards from the top of the fish-eye hole to the pipe bender base to fix the grooved disks.

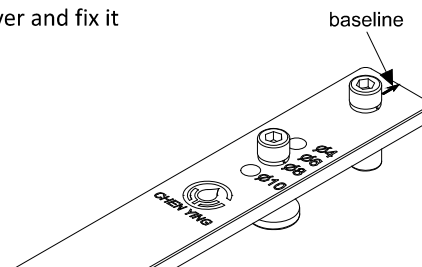

◆ Bending Instruction

1. Turn the bending lever to the starting point.

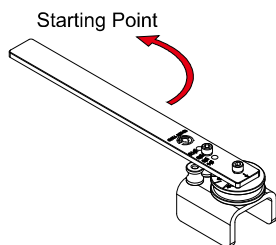

2. Insert the pipe and take the length needed for bending.

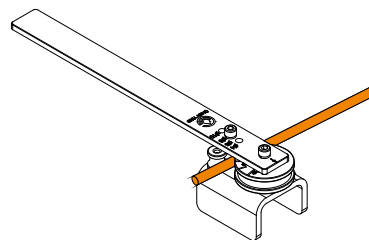

3. Turning the bending lever with the strength to the demand scale (align the baseline of the handle with the grooved disk's scale).

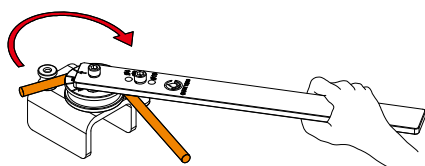

4. Turn the bending lever back to the starting point to remove the pipe.

