

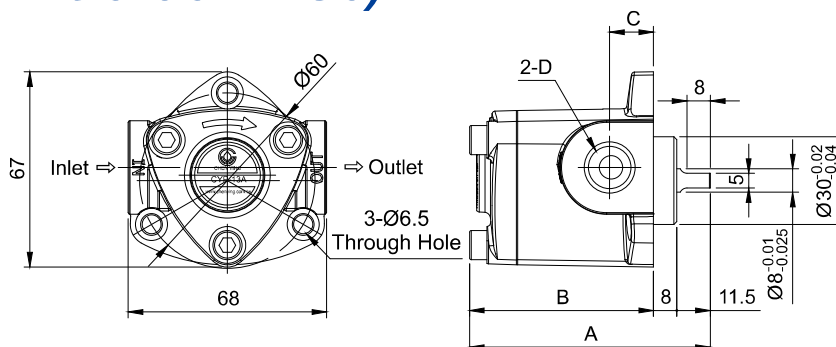

CHEN YING

Rotary Oil Pump (Clockwise or Anticlockwise)



◆Features

1. Rotary oil pump is also called trochoid oil pump or triangular oil pump. It can only rotate in one direction, clockwise or anticlockwise.
2. Standard rotary oil pump rotates clockwise, but anticlockwise is available on request.
3. The standard rpm is from 1420 to 1720 min⁻¹. Low rpm 450 to 1200 min⁻¹ is only available for CYP-12L type.
4. Recommend adding a CYP-AV adjustable pressure valve to a rotary oil pump. The range of pressure adjustment is 0 to 5 kgf/cm².
5. Recommend working with a 1/4HP motor. It is also suitable for working with CLSA, CLSB, and CLST circulating electric lubricators for lubricating and cooling purposes. It can be applied widely to various machines, such as special-purpose machines, machine tools, gearboxes, and cooling machines.

◆Dimensional Data & Technical Data

Model	Applicable Rotational Speed (min ⁻¹)	Discharge Volume (L/min)	A (mm)	B (mm)	C (mm)	D Bore	Max. Pressure	Suitable Viscosity	Suitable Temp. Range	N.W. (g)
CYP-10A	1420 - 1720	1.1 - 1.4	60.5	41	12	PT1/8	5 kgf/cm ²	32-68 cSt@40°C	0-90°C	616
CYP-11A-1	1420 - 1720	2.2 - 2.7	64.5	45	12	PT1/8				665
CYP-11A-2	1420 - 1720	2.2 - 2.7	64.5	45	12	PT1/4				664
CYP-12A	1420 - 1720	3.7 - 4.5	70.5	51	12	PT1/4				751
CYP-12L	450 - 1200	1.1 - 3.0	62.5	43	11	PT1/4				650
CYP-13A	1420 - 1720	6.5 - 7.9	82.5	63	15	PT3/8				924

※ If you need to add an adjustable pressure valve to the rotary oil pump, please add AV after the model number when you place an order. For example, CYP-11A-1-AV stands for one set of CYP-11A-1 assembled with CYP-AV.

※ After adding the adjustable pressure valve, the net weight increases by 110g.

Reversible Oil Pump (Clockwise and Anticlockwise)

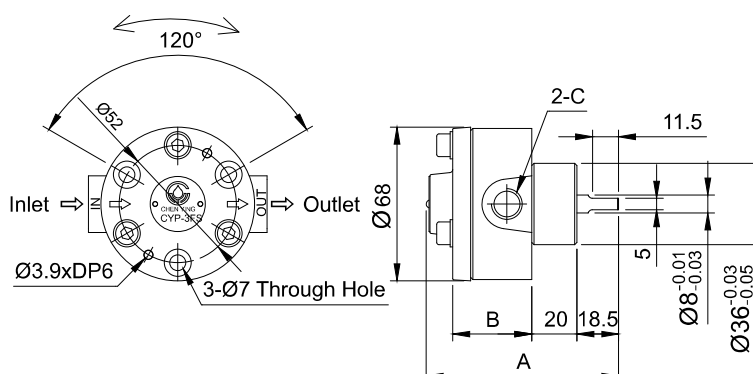

◆Features

1. The direction of the inlet and outlet is fixed; the rotating shaft can rotate either clockwise or anticlockwise.
2. It is only suitable for assembling with gearboxes, not with motors.

◆Dimensional Data & Technical Data

Model	Discharge Volume (L/min)		A (mm)	B (mm)	C Bore	Max. Rotational Speed (min ⁻¹)	Max. Pressure	Suitable Viscosity	Suitable Temp. Range	N.W. (g)
	1420min ⁻¹	1720min ⁻¹								
CYP-1FS	1.7	2.0	85	35	PT1/4	2000	5 kgf/cm ²	32-68 cSt@40°C	0-90°C	1000
CYP-2FS	2.7	3.2	89	39						1100
CYP-3FS	3.7	4.5	93	43						1200